

Soils Map

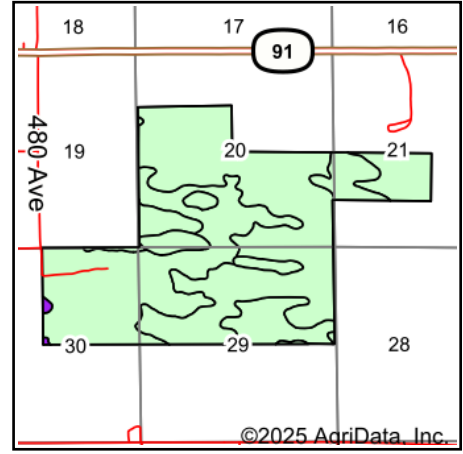
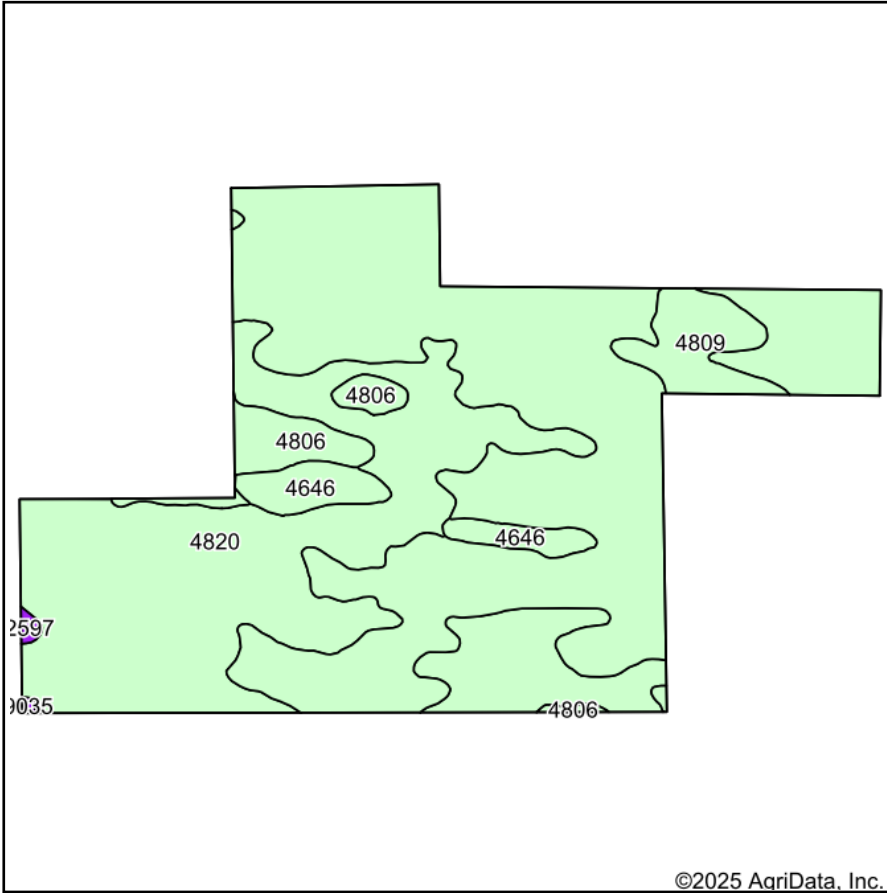

State: **Nebraska**
 County: **Garfield**
 Location: **20-21N-13W**
 Township: **Dry Cedar**
 Acres: **938.75**
 Date: **10/25/2025**

Maps Provided By:

 CUSTOMIZED ONLINE MAPPING
 © AgriData, Inc. 2023 www.AgriDataInc.com



Soils data provided by USDA and NRCS.

Area Symbol: NE071, Soil Area Version: 26

Code	Soil Description	Acres	Percent of field	SRPG Legend	Non-Irr Class *c	Irr Class *c	SRPG	Alfalfa hay Tons	Alfalfa hay Irrigated Tons	Corn Bu	Corn Irrigated Bu	Grain sorghum Bu	Grain sorghum Irrigated Bu	*n NCCPI Soybeans		
4806	Valentine fine sand, rolling, 9 to 24 percent slopes, moist	504.30	53.7%		Vle									16		
4820	Valentine loamy fine sand, 3 to 9 percent slopes, moist	363.92	38.8%		Vle	IVe		1	3		86			23		
4809	Valentine fine sand, rolling and hilly, 9 to 60 percent slopes, moist	35.98	3.8%		Vle									12		
4646	Ipaga loamy fine sand, 0 to 3 percent slopes	32.08	3.4%		IVe	IVe								22		
2597	Hersh fine sandy loam, 6 to 11 percent slopes	1.81	0.2%		IVe	IVe	53			1	4	18	5	11	44	
9035	Gates very fine sandy loam, 1 to 3 percent slopes	0.66	0.1%		Ile	Ile	59	3		5	37	118	43	94	50	
Weighted Average							5.92	*-	0.1	0.4	1.2	*-	33.5	*-	0.1	*n 18.8

*n: The aggregation method is "Weighted Average using all components"

*c: Using Capabilities Class Dominant Condition Aggregation Method

*- Irr Class weighted average cannot be calculated on the current soils data due to missing data.

Soils data provided by USDA and NRCS.